

Dear customer,

Thank you for choosing one of our products. Our name stands for high-quality, thoroughly tested products for applications in the areas of heat, gentle therapy, blood pressure/ diagnosis, weight, massage and air.

Please read these instructions for use carefully and observe the information they contain.

With kind regards,
Your Beurer team

1. Intended use 10
 2. Safety notes 10
 3. Getting to know your device 12
 4. Device description 12
 5. Initial use 13
 6. Operation 14
 7. Cleaning and maintenance 14
 8. Spare parts 16
 9. What if there are problems? 16
 10. Technical data 17
 11. Disposal 17



Warning!

Non-observance can lead to permanent injury or death.



Caution!

Non-observance can lead to minor injuries.



Important!

Non-observance can lead to material or environmental damage.



Cross-reference with another section.

Included in delivery

- Base unit for air humidifier
- Water tank for air humidifier
- Cleaning brush
- Instructions for use

1. Intended use

This air humidifier is designed for the humidification of ambient air.

The device is intended for private use.

2. Safety notes

- Read these instructions for use carefully. Non-observance of the following information may result in personal injury or material damage.
- Store these instructions for use and make them accessible to all users.
- Make sure to include these instructions for use when handing over the device to third parties.

- Only operate the device at the voltage indicated on the device (the type plate is located on the underside of the base unit).
- Only insert the mains cable into the socket when the device is switched off.
- Never use the device if it or its accessories are visibly damaged.
- Do not use the device if it has sustained a fall or if water has penetrated the device interior.
- Do not use the device during a storm.
- In the event of defects or operational faults, switch off the device immediately and disconnect the device from the mains socket.

Electric shock



Warning!

As with every electrical device, use this air humidifier carefully and cautiously, in order to avoid hazards due to electric shock.

- Do not pull on the mains cable or on the device to disconnect the plug from the socket.
- Never hold or carry the device by the mains cable.
- Do not clamp or pinch the mains cable.
- Keep the mains cable away from hot surfaces.
- Ensure that the mains cable and plug do not come into contact with water, steam or other liquids.
- Only use the device in dry internal rooms (e.g. never in the bathroom, sauna, etc.).
- Never reach for a device that has been submerged in water. Pull the plug out of the mains socket immediately.
- Do not subject the device to any impacts or drop the device.

Repairs



Warning!

- Do not open the base unit.
- Only specialist personnel may perform repairs on electrical devices. Improper repairs may subject users to considerable danger. For repairs, please contact customer service or an authorised retailer.
- If the mains cable of the device is damaged, it must be replaced by the manufacturer or an authorised customer service point.

Risk of fire



Warning!

There is a risk of fire if the device is used improperly or these instructions for use are ignored.

- Never use the device underneath a cover, such as a blanket or pillow.
- Never use the device near highly flammable substances.

Operation



Warning!

- The device is only intended for the purpose described in these instructions for use. The manufacturer is not liable for damage resulting from improper or careless use.
- This device is not intended for use by people (including children) with restricted physical, sensory or mental skills or a lack of experience and/or a lack of knowledge, unless they are supervised by a person who has responsibility for their safety or instructed by him in how to use the device.
- Children should be supervised around the device to ensure they do not play with it.
- If you suffer from a severe respiratory or lung disease, consult your doctor before using the air humidifier.
- The device must be switched off after every use and before cleaning. Pull the plug out of the mains socket.
- Ensure that the mains cable does not pose a trip hazard.



Caution!

- Ensure that the device is placed on a firm, flat surface that is not susceptible to moisture.
- Do not insert any objects into openings on the device. Ensure that the moving parts can move freely at all times.
- Do not place any objects on the device.
- Do not expose the device to high temperatures.

3. Getting to know your device

Humans spend a large proportion of their time indoors.

For ideal ambient air, a humidity level of between 40% and 60% is recommended. This value is often not reached, particularly in winter, when cold, dry air enters living spaces that are being aired and is then warmed up. This dry ambient air draws in moisture, drying out mucous membranes and skin, but also furniture.

Ambient air that is too dry may have a number of negative effects.

- Mucous membranes and lips dry out
- Eyes become irritated
- Infections and respiratory diseases are more likely to occur
- Exhaustion, tiredness and difficulty concentrating
- Pets and plants are put under unnecessary strain
- Dust forms more quickly
- Electrostatic charging of textiles made of synthetic fibres, such as carpets and plastic floor coverings
- Wooden furniture and, especially, parquet floors, are damaged
- Musical instruments go out of tune

4. Device description

The air humidifier

- humidifies the air,
- runs quietly and is continuously adjustable,

- is suitable for rooms up to 25 m² in size,
- has a low energy consumption and switches off automatically when the water tank is empty,
- is easy to clean,

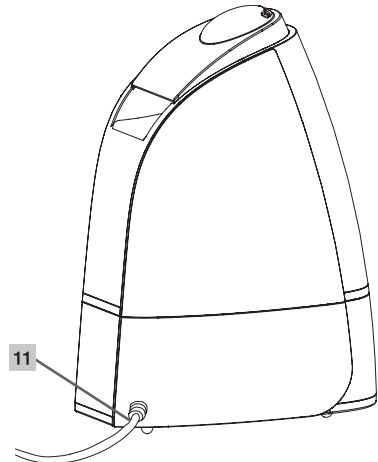
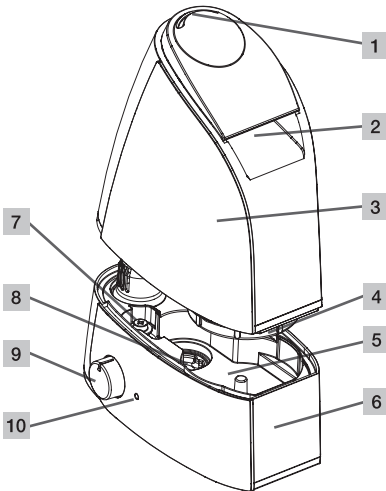

- 1 Mist outlet
- 2 Recessed grip
- 3 Water tank
- 4 Water tank screwed plug
- 5 Water basin
- 6 Base unit for air humidifier

- 7 Fill level sensor
- 8 Ultrasound membrane
- 9 Control dial
- 10 LED display
- 11 Mains cable

Principle behind the LB44 air humidifier

- [1] A membrane, vibrated by ultrasound, moves the water and releases tiny water droplets from the surface.
- [2] The fan draws in air at the bottom of the device.
- [3] The air is humidified with the released water droplets and blown gently upwards towards the opening.

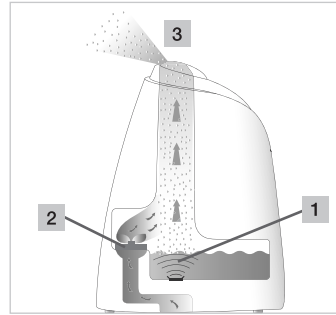

5. Initial use

Unpacking the device

⚠ Warning!

Keep packaging material away from children!
There is a choking hazard.

- > Open the cardboard packaging
 - > Remove the protective insert
- Keep the plastic film closed.*
- > Lift the device up and out of the packaging
 - > Remove the plastic covering
 - > Check the device, the mains plug and the cable for damage

Installation location

⚠ Warning!

Before putting the device into operation, read the safety notes in the Safety chapter.

▷ Safety pages 10 and 11

i Important!

- The immediate vicinity of the air humidifier can become damp.
- Calcareous water can leave white deposits.
- Do not place the device on the floor, but in a raised position (e.g. on a table or chest of drawers).
- Position the device so that the mist outlet is not directed towards objects.
- Empty any remaining water when the device is not in use.

- > Place the air humidifier on a firm, level and water-resistant surface

If the device should accidentally tip over, water may escape, even if the device is switched off and unplugged.

Water

i Important!

- Do not add any essential oils or fragrances to the water. If additives are used, the plastic material may become discoloured and damaged. The ultrasound membrane gets stuck and is damaged.
- Use fresh drinking water in the device. If the drinking water is very hard, you can use demineralised or distilled water.

Tip!

If the water is hard, we recommend using the optional anti-limescale filter.

▷ 8. Spare parts

Filling the water tank

- > Lift the water tank using the recessed grip and rotate it

The water tank is kept closed by means of a spring valve.

- > Open the screwed plug on the water tank
- > Fill with water

The water tank holds a maximum of 2.8 litres. The water level can be seen from the outside.

- > Tightly close the water tank using the screwed plug
- > Rotate the water tank, holding the recessed grip, and place it on the base unit

The tank should sit tightly on the base unit.

6. Operation

i Important!

Check the humidity of your ambient air regularly. Intensive continuous operation can cause the ambient air to become excessively humid. The relative air humidity should not exceed 60%.

Switching on the device

- > Insert the plug into the mains socket
- > From its minimum position, turn the control dial to the right

A green LED next to the control dial lights up.

If there is no or not enough water in the water tank, a red LED lights up.

The device has switched off for safety reasons.

- > Fill the water tank
- ▷ Fill the water tank as described under 5. Initial use.
- > Use the control dial to set the desired evaporation output

Evaporation is limited to a maximum of 220 ml per hour.

Switching off the device

- > Turn the control dial to the left as far as "0"
The LED next to the control dial goes out.
- > Pull the plug out of the mains socket

7. Cleaning and maintenance

Regular cleaning and disinfection are a prerequisite for hygienic and fault-free operation.

The level of contamination of the device depends on the water quality and how long it has been in operation. In any case, we recommend the following cleaning intervals.

Every three days	As required	
x		Clean the ultrasound membrane with a brush, rinse the base
x		Rinse the water tank, replace the water
	x	Clean the air intake filter on the underside
	x	Clean the air humidifier inside and out
	x	Descale

⚠ Warning!

The device must be switched off after every use and before cleaning. Pull the plug out of the mains socket.

⚠ Caution!

The water tank must be cleaned and the air humidifier completely emptied if the device has not been used for over a week.

i Important!

- Clean the device using only the methods specified.
- Under no circumstances may liquid enter the base unit.
- Do not use any solvent-based cleaning products.
- Only use a mild flushing agent or vinegar/vinegar-based cleaner to perform cleaning or disinfection work.

Cleaning the ultrasound membrane with a brush, rinsing the base

i Important!

Empty the water from the base unit via the side rim in the direction indicated by the arrow. Ensure that no water gets inside the device, e.g. via the fan opening.



- > Clean the ultrasound membrane using the cleaning brush provided
- > Empty the water from the base unit via the side edge

Observe the markings on the device!

- > Should dirty residue remain in the base unit, pour some clean, fresh water into the base unit and empty it out via the side edge

Rinsing the water tank, replacing the water

- > Clean the water tank regularly, at least once a week if using daily
- > Use a mild cleaning agent or vinegar/vinegar-based cleaner
- > Clean the thread of the screwed plug using a soft brush
- > Half-fill the water tank with water
- > Tightly close the water tank using the screwed plug
- > Shake the water tank by rocking it back and forth several times
- > Empty out the water completely
- > Repeat the process using clean, fresh water

Cleaning the air intake filter

- > Empty the water from the base unit via the side edge
- > Dry the base unit
- > Remove the air filter on the underside of the base unit from its holder
- > Carefully rinse out the air filter with water and leave it to dry
- > Insert the dried air filter into its holder on the underside of the base unit

Cleaning the air humidifier inside and out

- > Empty the water from the base unit via the side edge
- > Wipe the air humidifier with a damp cloth inside and out

Only use a mild flushing agent or vinegar/vinegar-based cleaner to perform cleaning work.

Descaling

Descaling the ultrasound membrane

Hard water can cause limescale to build up in the device and, especially, on the ultrasound membrane. This forms white deposits. Descale the device regularly.

- > Drop some descaler onto the ultrasound membrane
- > Leave it to take effect for two to five minutes
- > Clean the ultrasound membrane using the cleaning brush
- > Rinse the base unit twice with clean, fresh water

Cleaning inside the base unit

- > Dip a damp, soft cloth briefly in descaling solution
- > Use the cloth to wipe the inside of the base unit
- > Carefully pour some clean, fresh water into the base unit
- > Empty the water from the base unit via the side edge
- > Repeat the process using clean, fresh water

Descaling the water tank

- > Half-fill the water tank with water
- > Add a small quantity of descaler
- > Tightly close the water tank using the screwed plug
- > Shake the water tank by rocking it back and forth several times
- > Empty the descaling solution completely
- > Repeat the process twice using clean, fresh water

8. Spare parts

Tip!

If the water is hard, we recommend using the optional anti-limescale filter.

Anti-limescale filter (optional)
Order number 162.843. Please contact the national service address.



Important!

- If the anti-limescale filter does not prevent limescale build-up, or if white deposits form on or in the device, the anti-limescale filter should be replaced.
- The service life of the anti-limescale filter is around two to three months at most.
- If the device is not used for a relatively long time, the anti-limescale filter must be removed from the water tank and dried out.

Fitting the anti-limescale filter

- > Lift the water tank and rotate it
- > Open the screwed plug on the water tank
- > Screw the anti-limescale filter onto the screwed plug on the inside
- > Tightly close the water tank using the screwed plug

9. What if there are problems?

Problem	Cause	Solution
No LED display	The mains cable is not plugged in.	> Connect the plug
	The control dial is at its minimum position.	> Turn the control dial clockwise towards the maximum position
Red LED	The water level is too low; the water tank is empty.	> Fill the water tank
No mist is produced	The LED lights up green.	> Turn the control dial clockwise towards the maximum position
	The LED lights up red.	> Fill the water tank
	The LED display does not light up.	> Connect the plug
The mist has a strange smell	The device is new.	> Remove the water tank, turn the screwed plug and remove it > Air the open, empty water tank in a cool, dry place for twelve hours
	Stale or dirty water.	> Empty the base unit and the water tank and clean them thoroughly > Fill the water tank with fresh water
Strange noise	The water tank is not positioned correctly on the base unit.	> Lift up the water tank and position it correctly on the base unit <i>The tank should sit tightly on the base unit.</i>

Problem	Cause	Solution
Strange noise	There is too little water in the water tank.	> Fill the water tank
	The device is not level and unstable.	> Place the device on a firm, level surface
Mist escapes underneath the water tank.	The water tank is not positioned correctly on the base unit.	> Lift up the water tank > Check whether the join between the base unit and water tank is clean > Clean if required > Position the water tank correctly on the base unit <i>The tank should sit tightly on the base unit.</i>

10. Technical data

Dimensions (LxWxH)	approx. 25 cm x 12 cm x 34 cm
Cable length	approx. 1.5 m
Weight when empty	approx. 1.5 kg
Mains voltage/frequency	100-240 V AC / 50/60 Hz
Nominal power	20 watts
Room size	up to 25 m ²
Capacity	approx. 2.8 litres
Evaporation output	220 ml/hour
Signs and symbols	 The unit is double-protected and thus corresponds to protection class 2.

11. Disposal

Observe the local regulations for material disposal. Dispose of the device in accordance with EC Directive 2002/96/EC – WEEE (Waste Electrical and Electronic Equipment).

If you have any questions, please contact the local authorities responsible for waste disposal.

