

beko



Hood
User Manual

CFB 6400 XA

Please read this user manual first!

Dear Customer,

Thank you for preferring a Beko product. We hope that you get the best results from your product which has been manufactured with high quality and state-of-the-art technology. Therefore, please read this entire user manual and all other accompanying documents carefully before using the product and keep it as a reference for future use. If you handover the product to someone else, give the user manual as well. Follow all warnings and information in the user manual.

Do not dispose of the packaging materials together with the domestic or other wastes. Take them to the packaging material collection points designated by the local authorities.

Explanation of symbols

Throughout this user manual the following symbols are used:



Important information or useful hints about usage.



Warning for hazardous situations with regard to life and property.



Warning for electric shock.



Warning for danger of fire.



Warning for hot surfaces.



Packaging materials of the product are manufactured from recyclable materials in accordance with our National Environment Regulations.

Do not dispose of the packaging materials together with the domestic or other wastes. Take them to the packaging material collection points designated by the local authorities.



This product has been produced in environmentally friendly, modern facilities.

Complies with the WEEE Regulation.



Does not contain PCB.

Made in: P.R.C.

TABLE OF CONTENTS

1 Recommendations and Suggestions	4-5
1.1 General	4
1.2 Safety Precaution	4
1.3 Warning	5
2 Characteristics	6
2.1 Technical Specifications	6
3 Installation Instructions	7-9
4 Operation	9-10
5 Use and Maintenance	11
5.1 Carbon filter (not supplied)	12

1 Recommendations and Suggestions

1.1 General

- Carefully read the following important information  regarding installation safety and maintenance. Keep this information booklet accessible for further consultations.
- The appliance has been designed as a exhausting version (external exhaust) or as a filter version (inter air recycle) cooker hood.

1.2 Safety Precaution

- Take care when the cooker hood is operating simultaneously with an open fireplace or burner that depend on the air from the environment and are supplied by other than electrical energy, as the cooker hood removes the air from the environment which a burner or fireplace need for combustion.
- Provide adequate ventilation in the environment for a safe operation for the cooker hood.
- Follow the local laws applicable for external air evacuation
- Appliance shall only be used with rated voltage and frequency.
- There is a fire risk if cleaning is not carried out in accordance with the instruction.

- There shall be adequate ventilation of the room when the range hood is used at the same time as appliances burning gas or other fuels. (Not applicable to appliances that only discharge the air back into the room).
- There is a risk of fire if cleaning is not carried out in accordance with the instructions.
- Do not flambé under the range hood.



Accessible parts may become hot when used with a cooking appliance.

- The appliance is not intended for use by persons (including children) with reduced physical, sensory or mental capabilities, or lack of experience and knowledge, unless they have been given supervised or instruction concerning use of the appliance by a responsible person for their safety.
- Young children should be supervised to ensure that they do not play with the appliance.
- If the supply cord is damaged, it must be replaced by the manufacturer or its service agent or a similarly qualified person in order to avoid a hazard.

1 Recommendations and Suggestions

The instructions must include details concerning cleaning instructions and frequency of cleaning

1.3 Warning

In certain circumstances electrical appliances may be a danger hazard.

- Do not check the status of the filters while the cooker hood is operating.
- Do not touch the light bulbs after appliance use.
- Do not disconnect the appliance with wet hands and without to force the supply cord..
- Flame cooking is prohibited underneath cooker hood.
- Avoid free flame, as it is damaging for the filters and a fire hazard.
- Constantly check food frying to avoid that the overheated oil may become a fire hazard .
- Disconnect the electrical plug prior to any maintenance.
- Children don't recognize the risks of electrical appliance. Therefore use or keep the appliance only under supervision of adults and out of the reach from children.
- If the power cord is damaged, it must be replaced by the manufacturer or a qualified service engineer in order to avoid a hazard.

- Keep electrical appliances out of reach from Children or infirm persons. Do not let them use the appliances without supervision.
- Indoor use only.
- Do not dispose of electrical appliances as unsorted municipal waste, use separate collection facilities.
- Contact you local government for information regarding the collection systems available.
- If electrical appliances are disposed of in landfills or dumps, hazardous substances can leak into the groundwater and get into the food chain, damaging your health and well-being.
- When the appliance is not in use and before cleaning, unplug the appliance from the outlet.

2 Characteristics

2.1 Technical Specifications

	CFB 6400 XA
Width	645 mm
Depth	195 mm
Height	550 mm
Supply voltage	220 - 240 V ~ 50 Hz
Control	3 power levels
Suction power	180 m ³ /h
Motor power	100 W
Lamp power	2 x 40 W
Net weight	5,5 kg
Gross weight	7 kg
Color	Inox

Markings on the product or the values stated in other documents supplied with the product are values obtained under laboratory conditions as per relevant standards. These values may vary according to the usage of the product and ambient conditions.

3 Installation Instructions

- The exhaust air must not be discharged into a flue which is used for exhausting fumes from other appliances burning gas or other fuels. (Not applicable for appliances which only discharge air back into the room)
- The minimum distance between the supporting surface for the cooking vessels on the hob and the lowest part of the range hood: When the range hood is located above a gas appliance, this distance shall be 65cm. If the instructions for installation for the gas hob specify a greater distance, this must be taken into account. (The distance of 65cm can be reduced for non combustible parts of range hoods and parts operating at safety extra low voltage provided these parts do not give access to live parts. Distance may be reduced to 60cm to align with the AGA code.)
- Regulations concerning the discharge of air have to be fulfilled



Failure to install the screws or fixing device in accordance with the instructions may result in electrical hazards.

The cooker hoods should be placed at a distance of 65-75cm from the cooking surface for best effect. (See Pic 1)

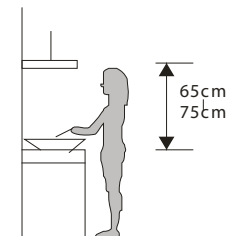

Pic 1

Way one: (See Pic 2)

- To install onto the wall drill 4 holes of Ø8 mm on a suitable place according with the centre distance of hole in the back of the cooker hood.
- Insert the nut into the holes.
- Insert the screws into the nut and tighten.
- Put up the cooker hood onto the fixed screws.
- Then use the attached accessories enclosed to turn the screws into the two holes of inside the hood, and then fix the screws to tighten the hood onto the wall.
- Put the one way valve onto the cooker hood.

Way two: (See Pic 2)

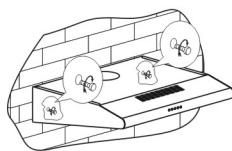

PIC2

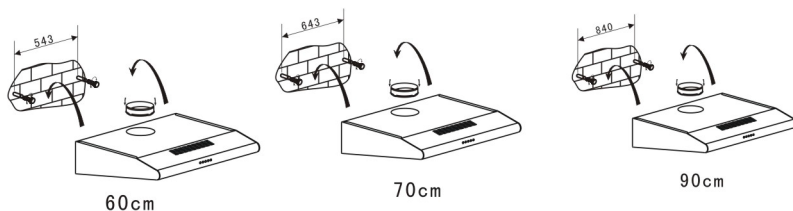

3 Installation Instructions

- Drill 6 holes of 4mm diameter at the bottom of the hanging cupboard.
- Put the one way valve on the cooker hood, then install the cooker hood on the bottom of the cupboard, tighten the hood with enclosed 6 screws.
- Install the adjusted board on the bottom of the hood in order to keep out the gap between hood back and cupboard.

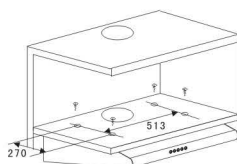

60cm

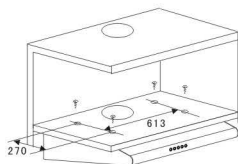

70cm

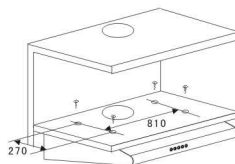

90cm

PIC3



There are 2 methods for ventilation, including 'horizontal ventilation' and 'vertical ventilation'. Please pay attention to the ventilation method when installation.

Horizontal ventilation:

As pic. 4A shown , please use the cover to seal the outlet on the top, then the air can be vented from back.

Vertical ventilation:

As pic 4B shown, please use the cover to seal the outlet on the back, then the air can be vented from top.

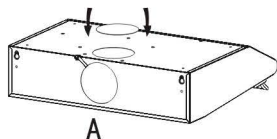

A

PIC4

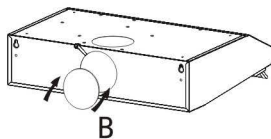

B

3 Installation Instructions

Air ventilation setting

Outdoor air ventilation:

Turn the adjuster to outdoor position(pic.5A), install the outlet, turn on the cooker hood, then the air will be vented from the outside outlet.

Indoor air ventilation:

Turn the adjuster to indoor position (pic.5B), install the outlet cover, turn on the cooker hood, then d from the inside outlet.

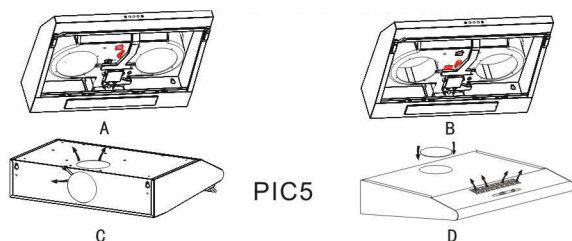

4 Operation

The switch is operated as below (see pic. 6) :

1. Press "0", the motor will be off.
2. Press the button to "low", "middle" and "high", the motor will be turned on at " low", "middle" and " high" speed respectively.
3. Press "light", the light will be on. Press it again, the light will be off.

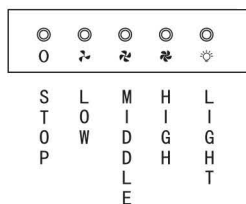

PIC6

5 Use and Maintenance

Changing and cleaning the filter.

The methods are as below (pic7) :

1. Put the filter into the water of 40-50°C, Put some detergent in , and leave it for 2-3 minutes . Then use the soft brush to clean it with proper strength , in order not to damage the filter.
2. The filter can be cleaned by dish washer. Put the filter into the dish washer and put some detergent in , then turn the temperature to 60°C.

All the filters are made of metal. Please do not use any corrosive detergent when cleaning .



Please unplug before cleaning.

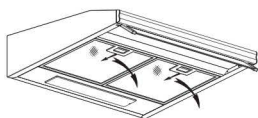

PIC7

Changing the light

- Before changing the lights, make sure that the appliance is plugged off.
- Open the filter , see beside picture.
- Change the Max. 40W E14 olive-shaped bulb.
- Replace the filter to the original position.

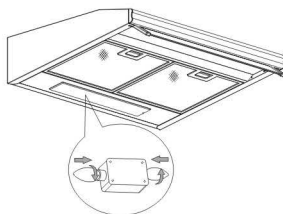



Beko Manufacturers Guarantee

Congratulations on purchasing a quality Beko product. Beko automatically provide you with a 2 year Manufacturers Guarantee, covering parts and labour for servicing within the geographical limits of Australia and New Zealand.

General Terms and Conditions

For Australian Consumers

This guarantee is an extra benefit and does not affect your legal rights. Our goods come with guarantees that cannot be excluded under the Australian Consumer Law. You are entitled to a replacement or refund for a major failure and for compensation for any other reasonably foreseeable loss or damage. You are also entitled to have the goods repaired or replaced if the goods fail to be of acceptable quality and the failure does not amount to a major failure.

For New Zealand Consumers

This guarantee is an extra benefit and does not affect your legal rights. Nothing in this guarantee purports to modify or exclude the conditions, guarantees and undertakings, and other legal rights, under the New Zealand Consumer Guarantees Act and other laws, except in those circumstances contemplated by section 43(2) of the New Zealand Consumer Guarantees Act.

Beko Guarantee

The Beko Manufacturers' Guarantee provides additional protection for your Beko Product, and it identifies a preferred approach to resolving product claims which will allow for a quick and simple process for all parties, subject to our terms and conditions below.

To enable us to assist you in the most expedient way please contact us by phoning the Toll free number (relative to your country of residence) as listed below. Please ensure you refer to your user manual and in particular the section headed **"Recommended Solutions for the problems"** before phoning.

The commencement date of this guarantee starts on the day of purchase and proof of purchase must be supplied to the Beko Service Centre prior to commencement of any guarantee work.

Terms and Conditions

Beko Australia and New Zealand Pty Ltd guarantees to the original purchaser to repair, or at its option replace, without charge to the owner for any part which is not of 'Acceptable quality' within two years of date of purchase.

"No Lemon Guarantee" * if the product fails more than 2 times during the Guarantee period due to the same type failure caused by the same part, we will automatically replace the product with an equivalent product free of charge.

Food Spoilage*

If your product is a fridge or freezer, we will reimburse you for food which due to a valid fault as per our guarantee is spoilt; reimburse you as per the benefits below:

Up to 200 Litre	\$100.00
>200 Litre - 400 Litre	\$200.00
>400 Litre - 600 Litre	\$300.00
>600 litre	\$350.00

* Subject to a valid claim under the terms and conditions of this Guarantee

To be eligible for this Guarantee the product must be purchased from an Authorised Reseller in Australia or New Zealand.

What is not covered under this Guarantee

1. Any service calls in which the problem is found not to be caused or related to any defect in the Product. In this instance, the cost of the service call will be charged to you. Examples (but not limited too) of no product fault listed below:
 - a. Correcting the installation, e.g. leveling of product, adjustment of drain
Crossed or kinked hoses, leakage of hoses if incorrectly fitted, removal of transit bolts (front loading washers), noises due to water hammer and/or power supplies.
 - b. Replacing fuses or correcting house power wiring or house plumbing issues
 - c. Failure due to incorrect set up or requiring instructions normally covered in user manual.
 - d. Blocked pumps, removal of foreign objects/substances from the washing Machine, e.g. socks, bra wires, dirt etc.
 - e. Normal noise or vibration
 - f. Infestation of pests, insects or vermin
2. This Guarantee does not cover damage caused by:
 - a. Misuse or abuse of the Beko Product
 - b. Accidental damage of any kind
 - c. Rust and Corrosion where the product is located within a corrosive environment
 - d. Discoloration of burners or trivets on gas cooktops or chrome surrounds
 - e. Incorrect operation or not following the operation instructions as stated in the user manual.
 - f. Improper installation
 - g. Failure to clean or improper cleaning
 - h. Use of incorrect non – compliant electrical or gas connections
 - i. External sources including but not limited to electrical interference, power surges or voltage fluctuations.
 - j. Any loss caused by civil commotion
 - k. Any loss caused from extreme events of nature including but not limited to, flood, cyclone, severe storm and earthquake
 - l. Use of non-genuine/authorised parts
 - m. Any repair or other work carried out on the Beko product other than by an authorised Beko Service Personnel.
3. This Guarantee does not cover costs associated with replacing and servicing of consumable parts. E.g. lamps & bulbs, filters

This Guarantee has been designed for Products used in normal domestic environment. Our products are not designed for commercial use. Any commercial use may affect this Product's Guarantee. Service under this Manufacturer's Guarantee is provided by the Beko Australia and New Zealand Authorised Repairer.

The Guarantee is provided by Beko Australia and New Zealand Pty Ltd (ABN: 49 152 055 162) of 55 Blanck Street, Ormeau, QLD Australia 4208, P O Box 354 Ormeau QLD Australia 4208.

In Australia if you need assistance.... Toll Free 1300 282 356

Email: Beko.care@Beko.com

In New Zealand if you need assistance.... Toll Free 0800 69 2356

Email: Beko.care@Beko.com

